



imla International
Master of Landscape
Architecture

Broaden your horizon:
Welcome to the internationally recognised
Master's programme in Landscape Architecture



The International Master's Programme in Landscape Architecture (known as the IMLA programme) is a cooperation between two renowned universities in Germany:

- **Nürtingen-Geislingen University (HfWU)**
in Nürtingen (Baden-Württemberg)
- **Weihenstephan · Triesdorf University of Applied Sciences (HSWT)**
in Freising (Bavaria)



Location of the IMLA partner universities



The location of studies alternates annually between Nürtingen and Freising-Weihenstephan – depending on the year of the application

- Nürtingen-Geislingen University of Applied Sciences (HfWU) near Stuttgart (Baden-Wuerttemberg)
- Weihenstephan · Triesdorf University of Applied Sciences (HSWT) near Munich (Bavaria)



IMLA heads of the programme



Nürtingen-Geislingen University (HfWU)

Dr. Ellen Fetzer
IMLA Programme Director

Prof. Dr. Michael Roth
IMLA Study dean



Weihenstephan-Triesdorf University of Applied Sciences (HSWT)

Prof. Tilman Latz
IMLA Study dean

Stefanie Gruber
IMLA Programme Coordinator



Definition of Landscape Architecture



IMLA follows the definition coined by ECLAS, the European Council of Landscape Architecture Schools:

'Landscape architecture as a field of professional activity, and an academic discipline, is concerned with the shaping of landscapes at **various scales**.

Core competences of landscape architecture centre on the process of intervention in landscapes to create new or revitalised places, by means of **landscape planning, design and management**, as well as by project implementation.'

Tuning Document, 2011





... means landscape unlimited



Shaping transformation,
planning and designing landscape
with innovative methods
and in international contexts

What does the programme offer?



Planning and design in Europe and beyond:

- Broaden your horizon in international contexts
- Learn about different (planning) cultures
- Develop your self-confidence



Photo source: Caroline De Vries



What does the programme offer?



Preparation for management functions:

- Organisational foresight, team building and leadership in projects
- Project and process management
- Public relations, communication and participation



What does the programme offer?



Working efficiently in (interdisciplinary and intercultural) teams:

- Teamwork and interdisciplinarity, intercultural communication
- Time management and work flow
- Planning and design methods and international approaches



What does the programme offer?



Creating ideas and solutions for landscapes throughout Europe:

- Current project tasks in different contexts
- Intensive studio work and landscape architecture research
- Application and development of digital technologies and tools

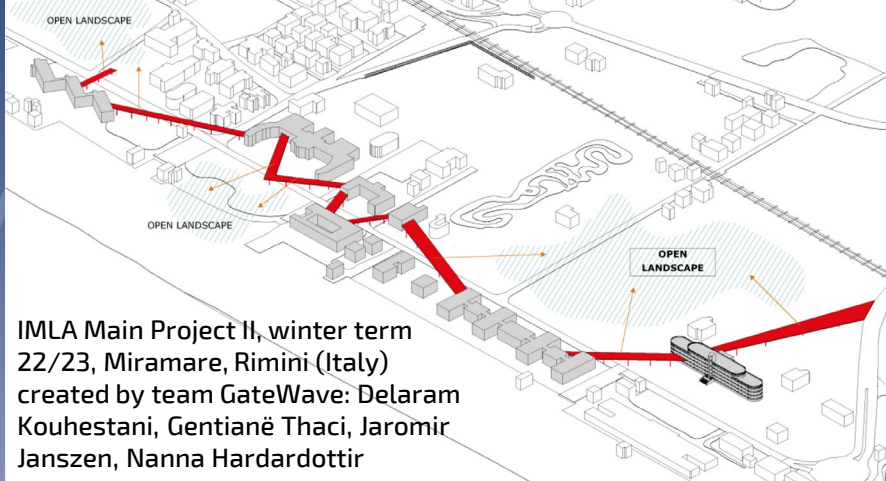

IMLA Main Project II, winter term
22/23, Miramare, Rimini (Italy)
created by team GateWave: Delaram
Kouhestani, Gentianë Thaci, Jaromir
Janszen, Nanna Hardardottir



The IMLA concept (course contents)

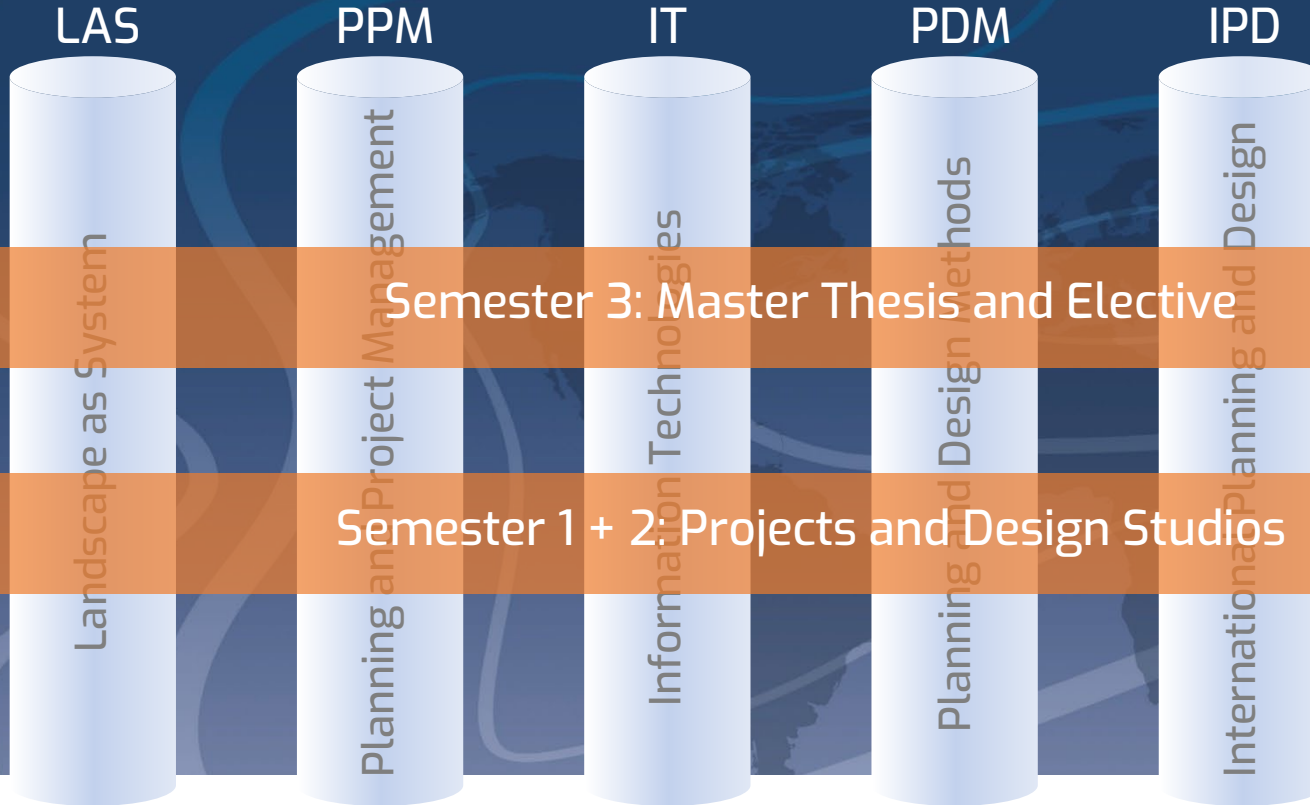

Theoretical basics – 5 pillars

Programme 2026 – 2028

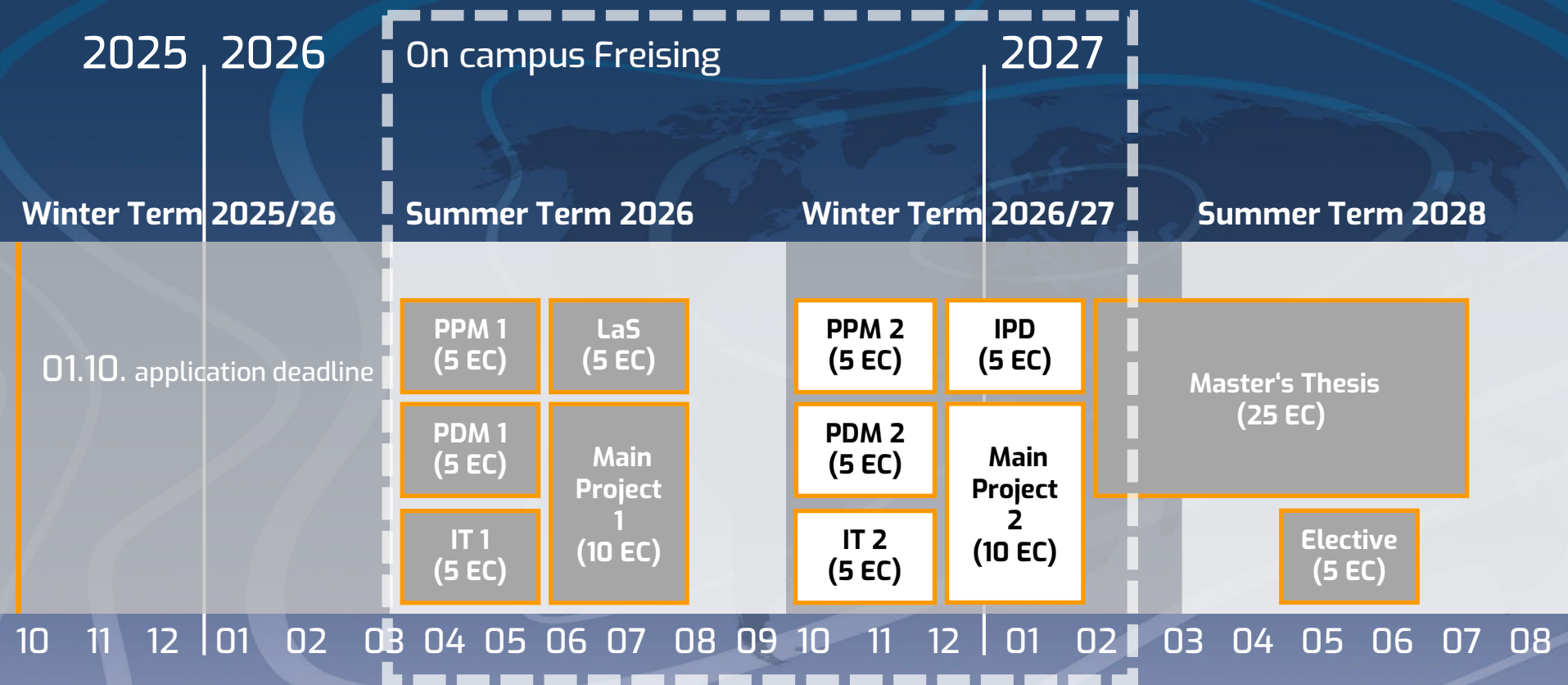

Students with a 3-year degree or a degree other than Landscape Architecture must complete a 18-week (90 days) internship at a Landscape Architecture Office before starting their Master's thesis.

Where do our students come from?

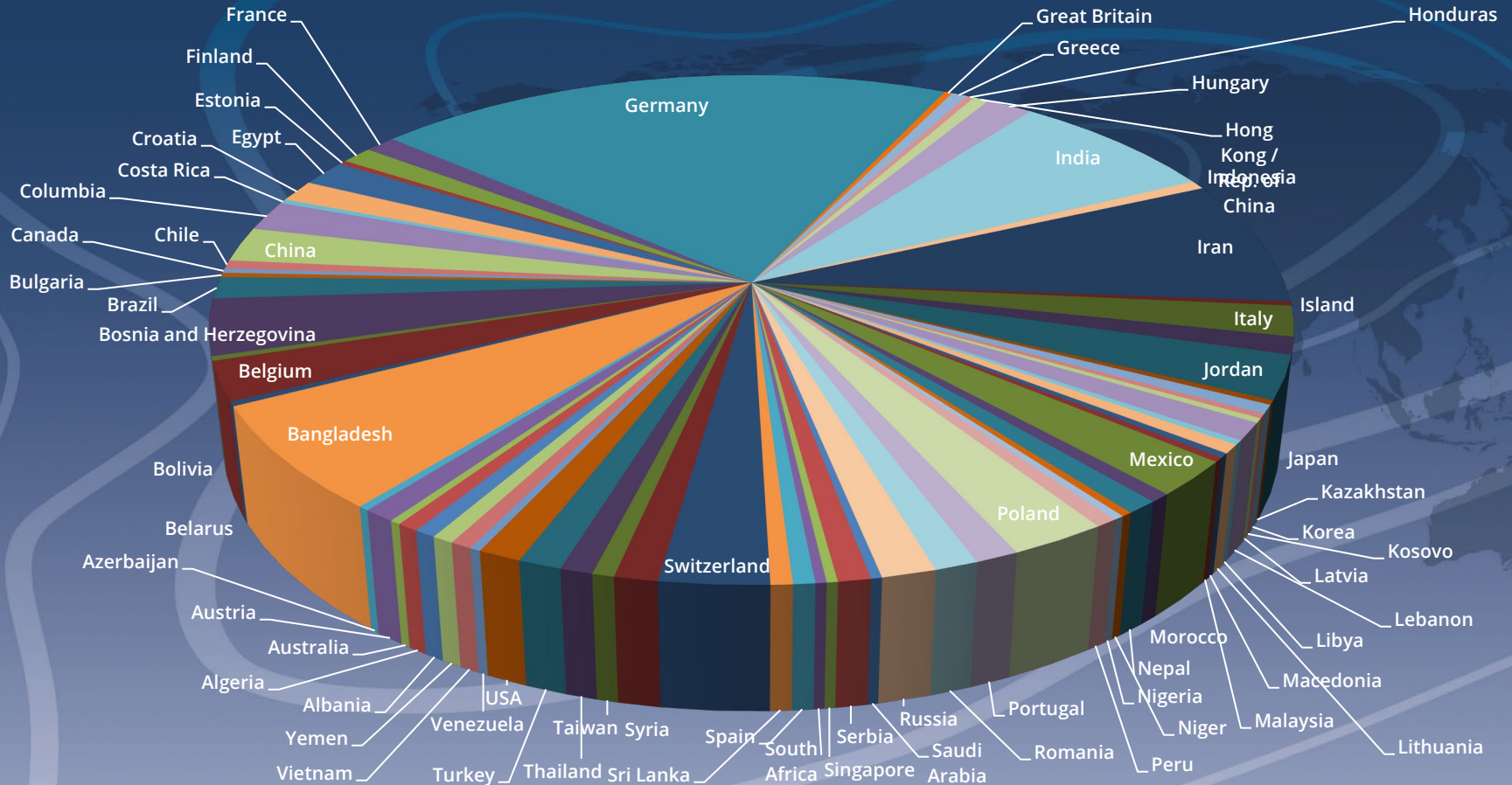

IMLA students Weihenstephan 2022 – 2024

26 students from 16 different nations (graduated last year)



IMLA students Nürtingen 2023 – 2025

32 students from 14 different nations (mainly graduated in February)



IMLA students Weihenstephan 2024 – 2026

27 students from 15 different nations (currently in the 3rd semester)



International projects / cooperation with partner universities



- 2011: Targu Mures (Romania) with Corvinus University Budapest
- 2012: Cape Town (South Africa) mit University of Cape Town
- 2013: Bucharest (Romania) with Ion Mincu University Bucharest
- 2014: Bruxelles (Belgium) with Université Libre Buxelles
- 2015: Sarajevo (Bosnia) and Romania (2 groups)
- 2016: Sarajevo (Bosnia)
- 2017: Sighisoara/Schäßburg (Siebenbürgen, Romania), Bergamo (Italy)
- 2018: Mangalia (Romania, Black Sea), Bergamo (Italy), Zagreb (Croatia)
- 2019: Tallinn (Estonia), Naples (Italy), Pula (Croatia), Bratislava (Slovakia)
- 2020: De Panne (Belgium), Düsseldorf (Germany), Gdansk (Poland)
- 2021: Rimini (Italy)
- 2022: Tartu (Estonia), Naples (Italy), Constanta (Romania), Rimini (Italy)
- 2023: Ravenna (Italy), Tartu (Estonia)
- 2024: Budapest (Hungary) with MATE, Ameland (The Netherlands) with Van Hall Larenstein University



Main Project II (winter term 2019/20): CAMPULA – University Campus Pula (Croatia)

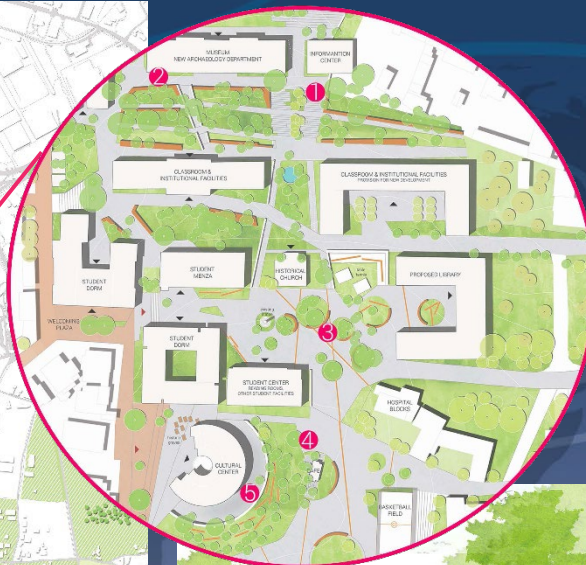
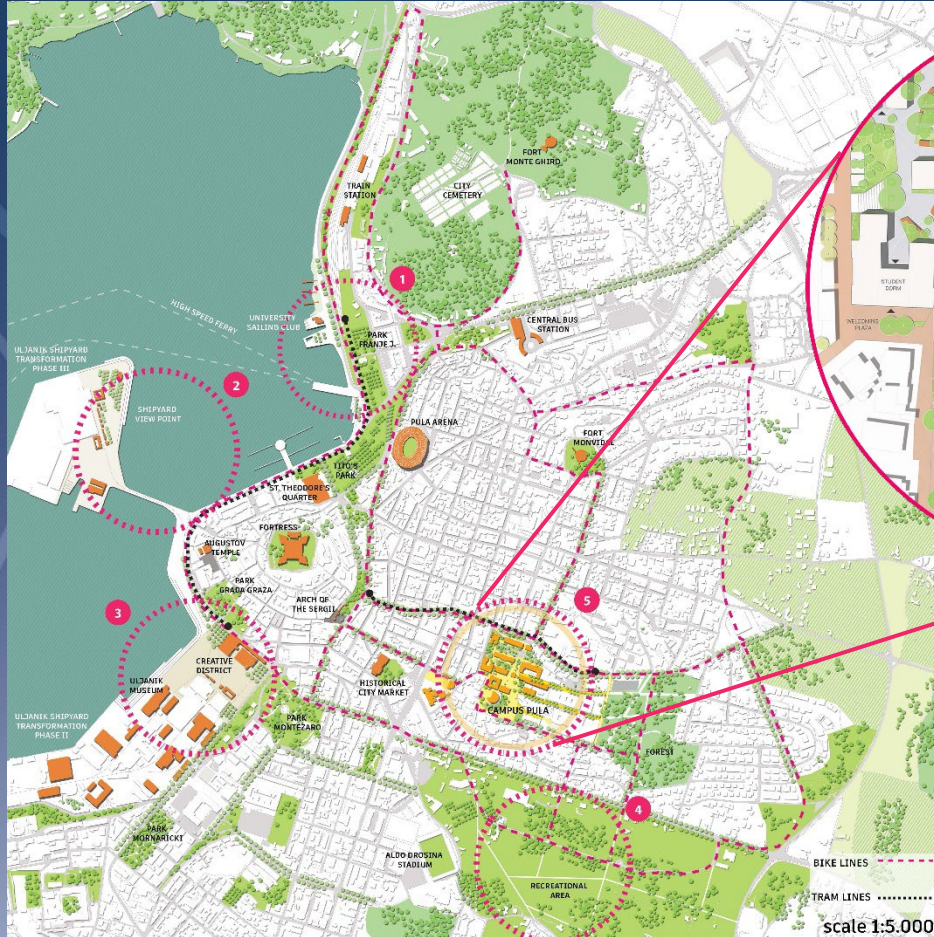

'INTERFACE'
Team:
Darja Korjukina,
Majeda Khatun,
Rahnuma Ahmad
Tahiti,
Göksen Ezgi Boz



Main Project II (winter term 2022/23): Urban Acupuncture in Rimini, Italy

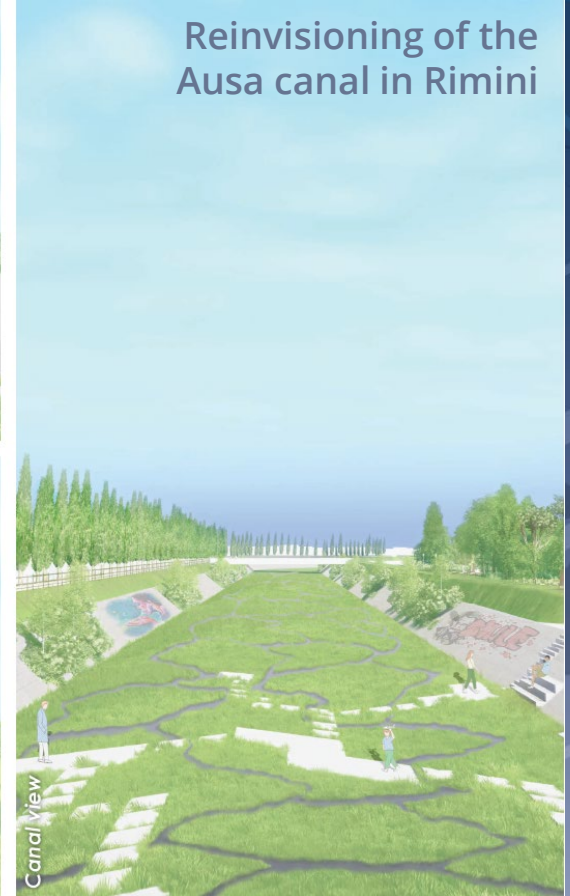

Team: Ayse Dolanbay, Fabrizio Albion, Kees van Roon, Pasu Vascharaprakarn

Awards and competition winners



bdla Bavaria Award 2020
 ‚Best Master’s Thesis‘ for two IMLA students:

Sarah Jankowski (left):
 ‚Sarajevo - The City as a Campus
 Universities as Impulses for
 Sustainable Urban Development‘
 Raphaela Roming (right):
 ‚Climate responsive Design –
 Klimagerechte Landschaftsarchitektur‘

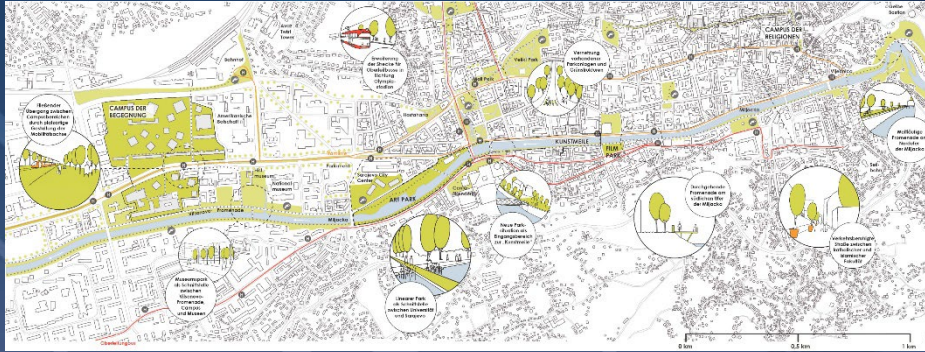

DESIGN

ANALYSE & AUSWERTUNG

KONZEPT-ENTWICKLUNG

ENTWURF: „DIE GRÜNE MARKTHALLE“

ANWENDUNG DER BEWERTUNGS- UND PLANUNGSSTRATEGIEN AM RATHAUSPLATZ

GRUNDLAGEN	STADTKLIMA-ANALYSE GRUNDLAGE: KLIMAAATLAS STUTT GART	KLIMATOP-ANALYSE EIGENE ANALYSEN / BEOBACHTUNGEN	AUSWERTUNG & KONZEPTENTWICKLUNG
<p>STADTKLIMA & EINFLUSSFAKTOREN</p>	<p>KLIMATOP ANALYSE</p>	<p>DIE GRÜNE MARKTHALLE</p> <p>ANALYSEERGEBNISSE</p>	
<p>KONZEPTENTWICKLUNG</p>	<p>MASSNAHMEN ZUR MIKROKLIMAOPTIMIERUNG</p>		

Competition winners



LE:NOTRE Landscape Forum 2020
Students' Competition 'Cross-Border Landscapes'
(Slovakia/Austria/Hungary)

2nd price
Team:
Chiara Loffredi,
Foyсал Md. Azizul
Karim,
Ho Ching Leung,
Shaurav Paul



Competition winners



LE:NOTRE Landscape Forum 2021
Students' Competition
'The Port Island of the Future'
(Gdańsk, Poland)

2nd price
Team:

Raquelle El-Khoury, Paul Maksoud,
Luke Miller, Taha Shayestehpour



Competition winners

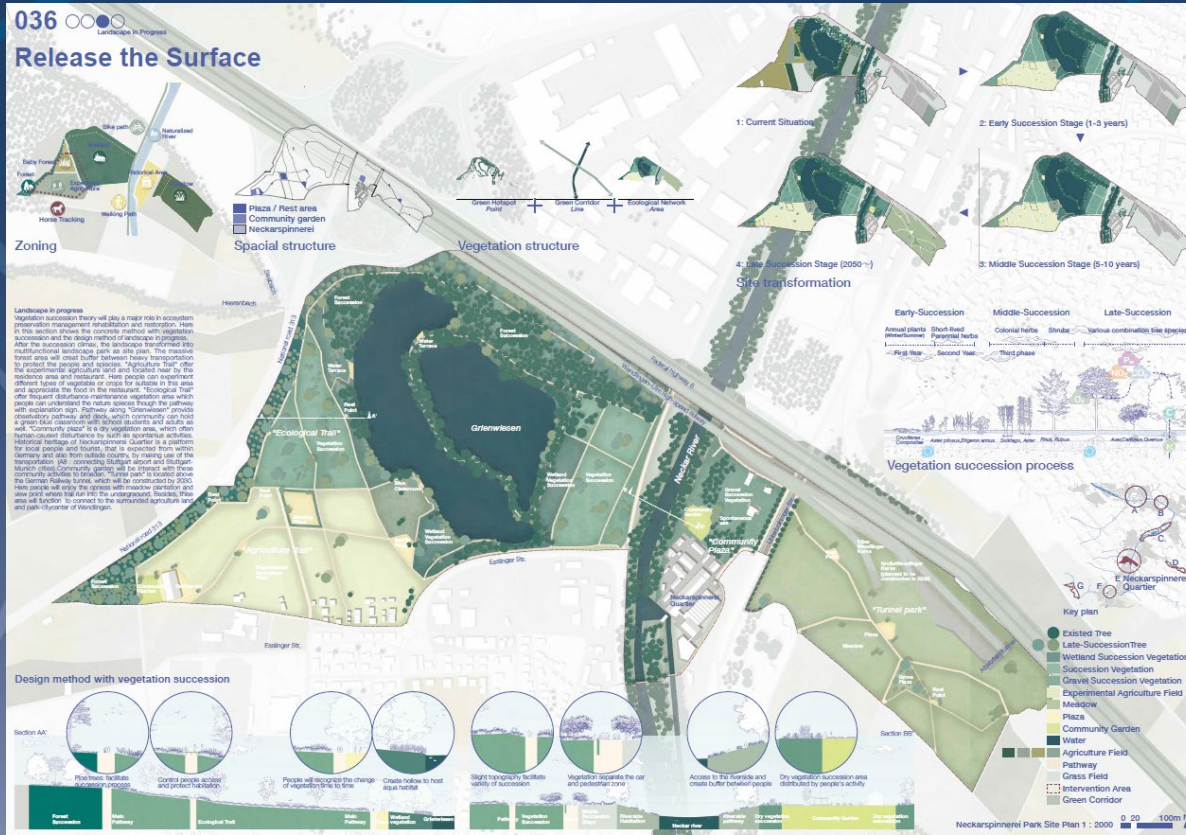

LE:NOTRE Landscape Forum 2023, Students' Competition 'Neckar Landscape Park – Re-imagining the Productive City Region' (Germany) 2nd price Yuga Tanaka

Competition winners



LE:NOTRE Landscape Forum 2024,
Students' Competition 'Exploring
Tartu Emajõgi and its watercourses'
(Tartu, Estonia): 1st price
Team: Caroline de Vries, Malavika
Mohan Das, Mahan Esmaili Zavieh,
Ernesto Velasquez Gonzalez



Interest?



- Start:** Every summer term (15 March)
 - Application deadline:** 01 October 2025 for 2026
 - Requirements:** Bachelor's degree in Landscape Architecture or related disciplines with a planning and spatial relevance
 - Further criteria:** Content relevance of the Bachelor's thesis, relevant professional experience, portfolio.
Students with a 3-year degree or a degree other than Landscape Architecture must complete a 18-week internship in the 3rd semester.
 - Teaching language:** English, Level B2 (CEFR) is to be verified
 - Learn more:** www.imla-campus.eu (including the IMLA image movie)
 - Application procedure:** <https://www.imla-campus.eu/application>
- Attention: foreign degree certificates need to be recognized in good time before your application to the Master's programme. Degree holders from India, Vietnam and China need additionally a valid APS certificate before they can apply for the degree recognition.



wants you!

Apply by 01 October 2025 for a start
in March 2026 in Freising-
Weihenstephan, HSWT



The best 75 applicants will be invited to
an online interview.

Let's shape our green future!

<https://www.imla-campus.eu/>