



imla

International
Master of Landscape
Architecture

**Broaden your horizon:
Welcome to the internationally recognised
Master's programme in Landscape Architecture**

The **International Master's Programme in Landscape Architecture** (known as the **IMLA** programme) is a cooperation between two renowned universities in Germany:

- **Nürtingen-Geislingen University (HfWU)**
in Nürtingen (Baden-Württemberg)
- **Weihenstephan · Triesdorf University of Applied Sciences (HSWT)**
in Freising (Bavaria)



WEIHENSTEPHAN · TRIESDORF
University of Applied Sciences

Location of the IMLA partner universities



The location of studies alternates annually between Nürtingen and Freising-Weihenstephan – depending on the year of the application

- Nürtingen-Geislingen University of Applied Sciences (HfWU) near Stuttgart (Baden-Wuerttemberg)
- Weihenstephan · Triesdorf University of Applied Sciences (HSWT) near Munich (Bavaria)



IMLA programme directors and coordinators



Nürtingen-Geislingen University (HfWU)

Dr. Ellen Fetzer

IMLA Programme Coordinator



Weihenstephan · Triesdorf University of Applied Sciences (HSWT)

Prof. Ingrid Schegk

IMLA Programme Director



Stefanie Gruber

IMLA Programme Coordinator



Definition of Landscape Architecture



IMLA follows the definition coined by ECLAS, the European Council of Landscape Architecture Schools:

'Landscape architecture as a field of professional activity, and an academic discipline, is concerned with the shaping of landscapes at **various scales**.

Core competences of landscape architecture centre on the process of intervention in landscapes to create new or revitalised places, by means of **landscape planning, design and management**, as well as by project implementation.'

Tuning Document, 2011





... means landscape unlimited



Shaping transformation,
planning and designing landscape
with innovative methods
and in international contexts

What does the programme offer?



Planning and design in Europe and beyond:

- Broaden your horizon in international contexts
- Learn about different (planning) cultures
- Develop your self-confidence



What does the programme offer?



Preparation for management functions:

- Organisational foresight, team building and leadership in projects
- Project and process management
- Public relations, communication and participation



What does the programme offer?



Working efficiently in (interdisciplinary and intercultural) teams:

- Teamwork and interdisciplinarity, intercultural communication
- Time management and work flow
- Planning and design methods and international approaches



What does the programme offer?



Creating ideas and solutions for landscapes throughout Europe:

- Current project tasks in different contexts
- Intensive studio work and landscape architecture research
- Application and development of digital technologies and tools



IMLA Main Project II, winter term 22/23
Miramare, Rimini (Italy)
created by team GateWave:
Delaram Kouhestani
Gentianë Thaci
Jaromir Janszen
Nanna Hardardottir

Course contents



LAS

Landscape as System

PPM

Planning and Project Management

IT

Information Technologies

PDM

Planning and Design Methods

IPD

International Planning and Design

Semester 3: Master Thesis and Elective

Semester 1 + 2 Projects and Design Studios

Theoretical basics – 5 pillars

Programme 2024 - 2025

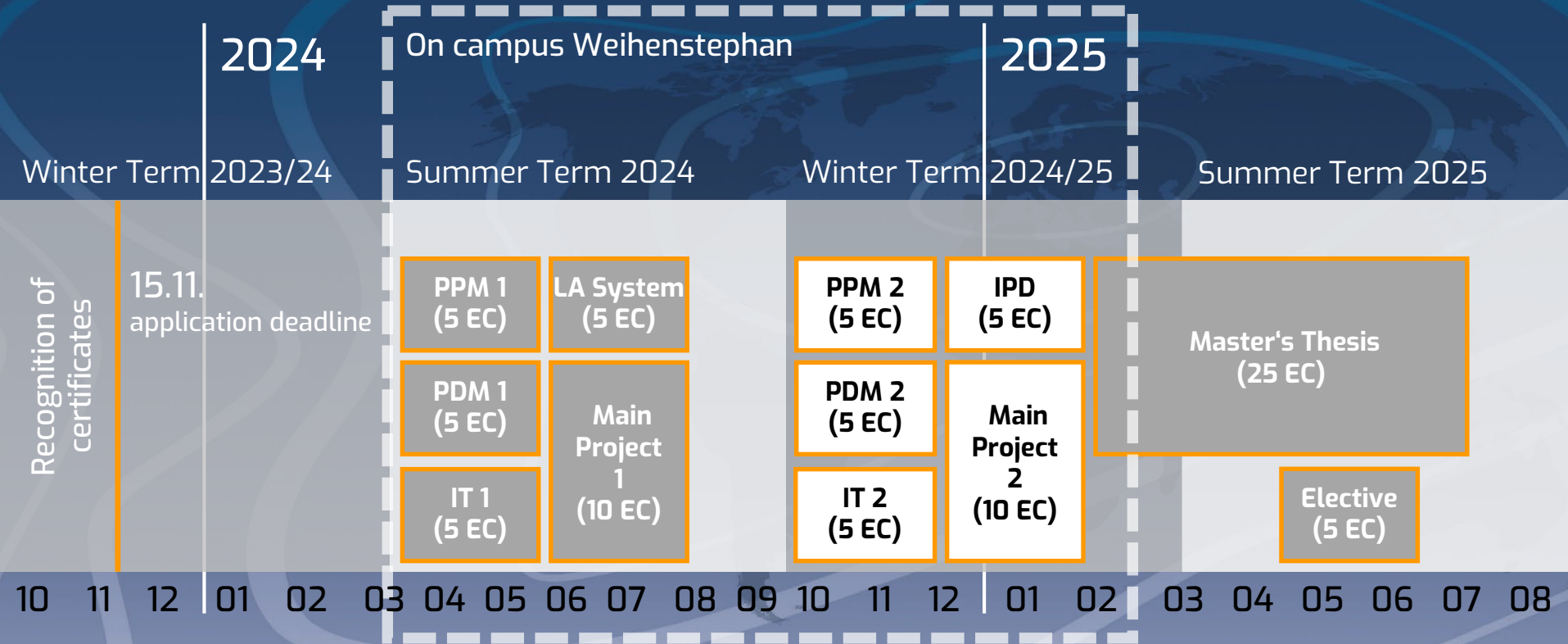

Students with a 3-year degree or a degree other than Landscape Architecture must complete a 18-week internship (90 working days) at a Landscape Architecture Office before starting their Master's Thesis.

Where do our students come from?

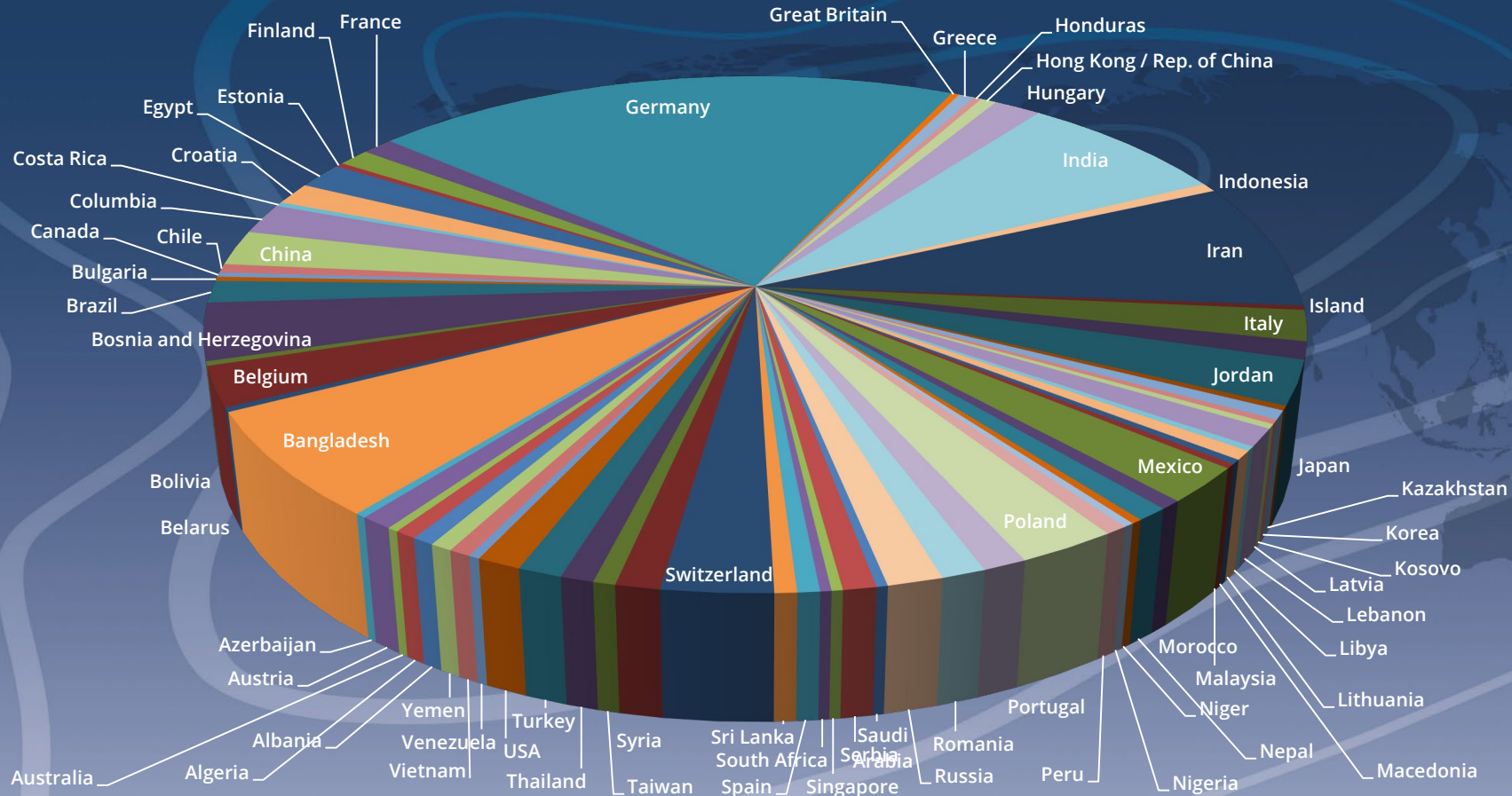

IMLA students Weihenstephan 2018 – 2020

29 students from 19 different nations



IMLA students Nürtingen 2019 – 2021

25 students from 15 different nations



IMLA students Weihenstephan 2020 – 2022

36 students from 18 different nations



IMLA students Nürtingen 2021 – 2023

29 students from 15 different nations



IMLA students Weihenstephan 2022 – 2024

25 students from 16 different nations



Project sites since 2001 in 15 different countries



International projects / cooperation with partner universities



- 2011: Targu Mures (Romania) with Corvinus University Budapest
- 2012: Cape Town (South Africa) mit University of Cape Town
- 2013: Bucharest (Romania) with Ion Mincu University Bucharest
- 2014: Bruxelles (Belgium) with Université Libre Buxelles
- 2015: Sarajevo (Bosnia) and Romania (2 groups)
- 2016: Sarajevo (Bosnia)
- 2017: Sighisoara/Schäßburg (Siebenbürgen, Romania), Bergamo (Italy)
- 2018: Mangalia (Romania, Black Sea), Bergamo (Italy), Zagreb (Croatia)
- 2019: Tallinn (Estonia), Naples (Italy), Pula (Croatia), Bratislava (Slovakia)
- 2020: De Panne (Belgium), Düsseldorf (Germany), Gdansk (Poland)
- 2021: Rimini (Italy)
- 2022: Tartu (Estonia), Naples (Italy), Constanta (Romania), Rimini (Italy)



Main Project II (winter term 2018/19): LEARNING LANDSCAPES – Zagreb Futurescapes (Croatia)

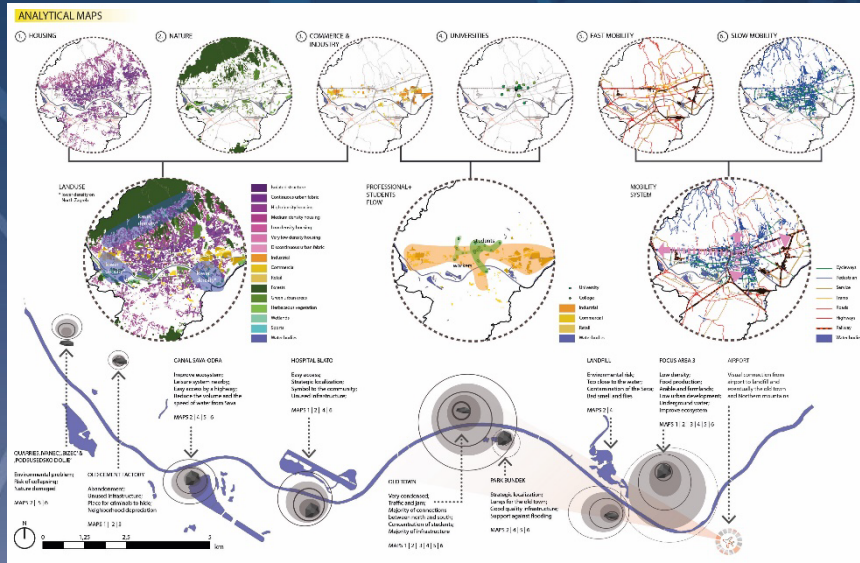

<<< ,The Ripple Effect', Team: Bruna Spagnol, Ho Sin Yee, Ivan Oskian, Rana Shukayr

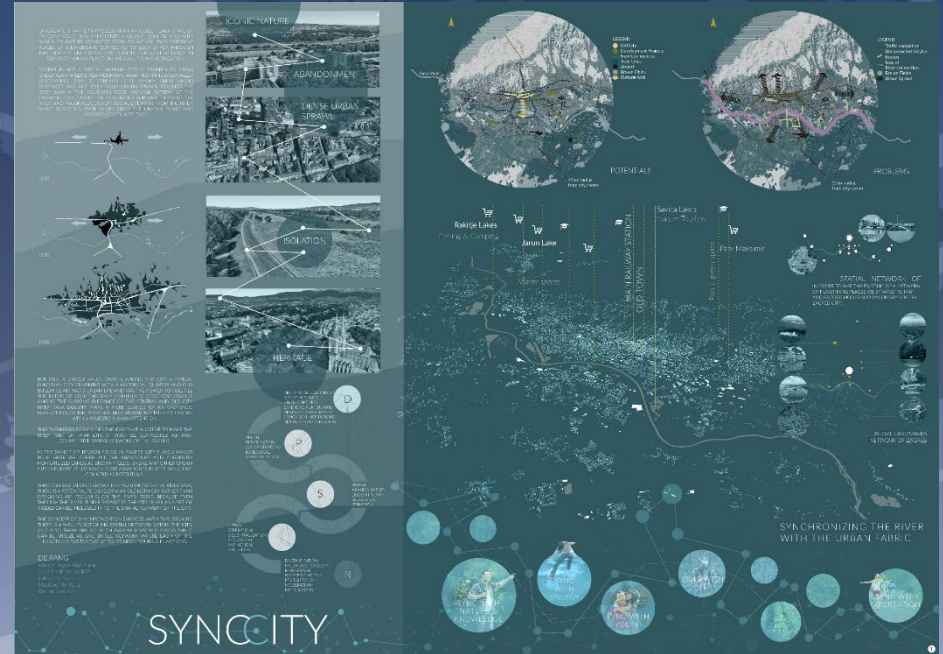

,SYNCCITY' >>>

Team: Sudara Jayalath, Lubna Mansour, Ahmed Ragab Abdelhafaz, Mastaneh Mahfouzi, Rashad Gasimov

Main Project II (winter term 2019/20): CAMPULA – University Campus Pula (Croatia)

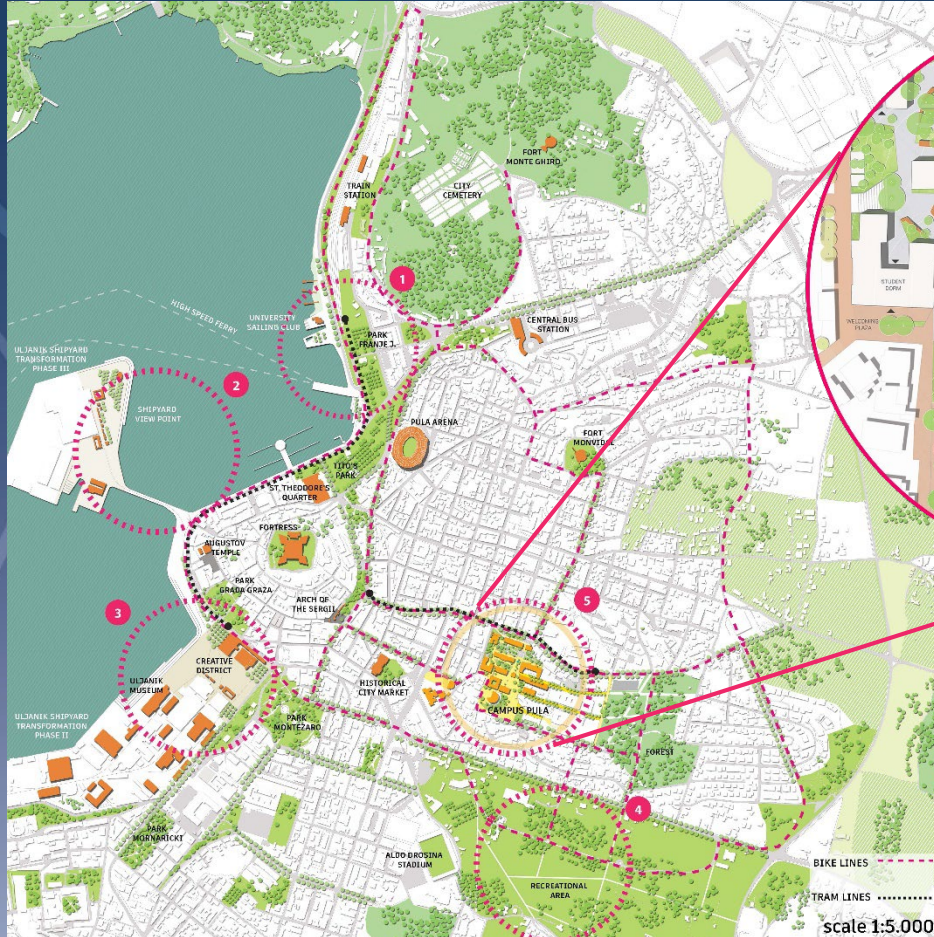

'INTERFACE'
Team:
Darja Korjukina,
Majeda Khatun,
Rahnuma Ahmad
Tahiti,
Göksen Ezgi Boz



Main Project II (winter term 2020/21): ALONG THE RRX RAILWAY LINE – Düsseldorf

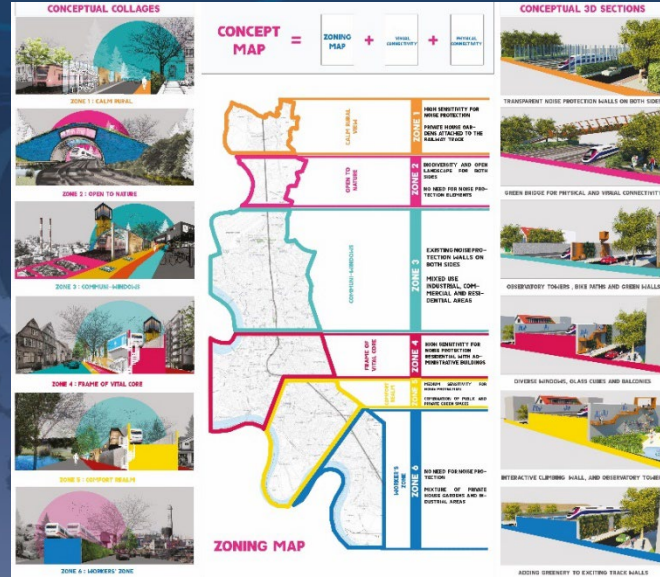
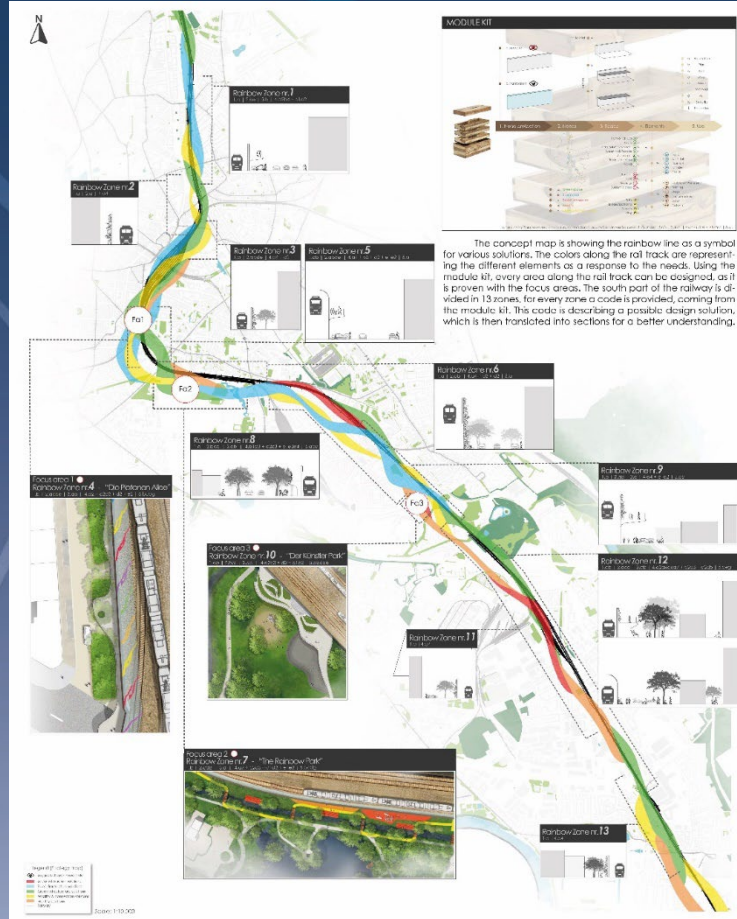

<<<
'The Rainbow Line'
Team:
Bogdan Draghici,
Imad Lallouche,
Theresa Pichler

<<<
'Urban Windows'
Team:
Mahmoud Elsherif,
Marco Louka,
Tejashree
Pandit,
Ghodsieh
Samani

Main Project II (winter term 2022/23): Urban Acupuncture in Rimini, Italy



Birds-eye view



Connection to the AUSA canal



Square



AUSA park

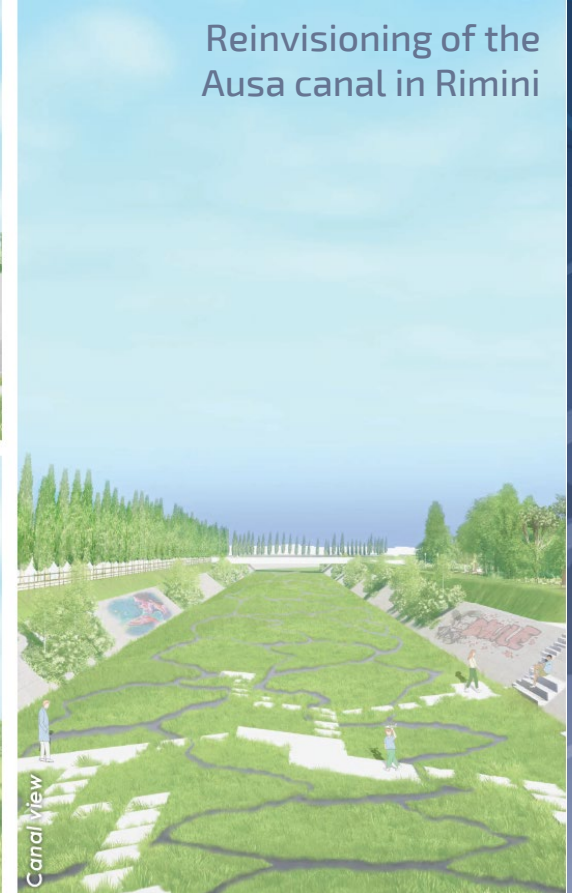

Reinvisioning of the
AUSA canal in Rimini

Canal view

Awards for IMLA students



bdla Bavaria Award 2017
,Best Master's Thesis'
for
Klaudia Jaskula:
,Lost Rivers in Lodz'



Awards for IMLA students



bdla Bavaria Award 2020
 ‚Best Master’s Thesis‘ for two IMLA students:

Sarah Jankowski (left):
 ‚Sarajevo - The City as a Campus
 Universities as Impulses for
 Sustainable Urban Development‘

Raphaela Roming (right):
 ‚Climate responsive Design –
 Klimagerechte Landschaftsarchitektur‘

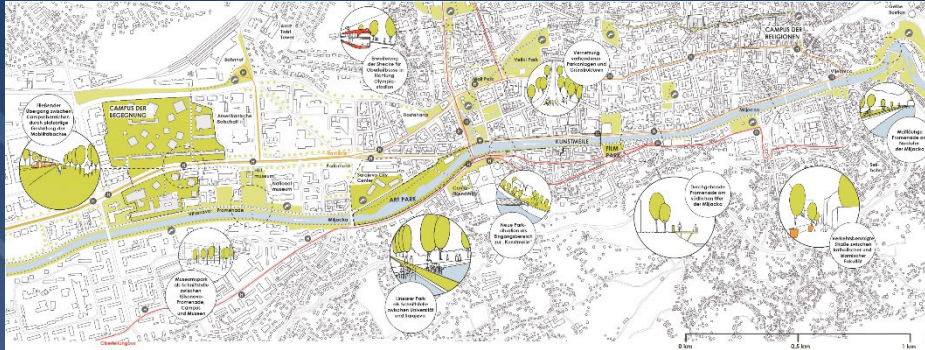

Competition winners



LE:NOTRE Landscape Forum 2020
Students' Competition 'Cross-Border Landscapes'
(Slovakia/Austria/Hungary)

2nd price
Team:
Chiara Loffredi,
Foyсал Md. Azizul
Karim,
Ho Ching Leung,
Shaurav Paul



Competition winners



LE:NOTRE Landscape Forum 2021
Students' Competition
'The Port Island of the Future'
(Gdańsk, Poland)

2nd price
Team:

Raquelle El-Khoury, Paul Maksoud,
Luke Miller, Taha Shayestehpour



Competition winners

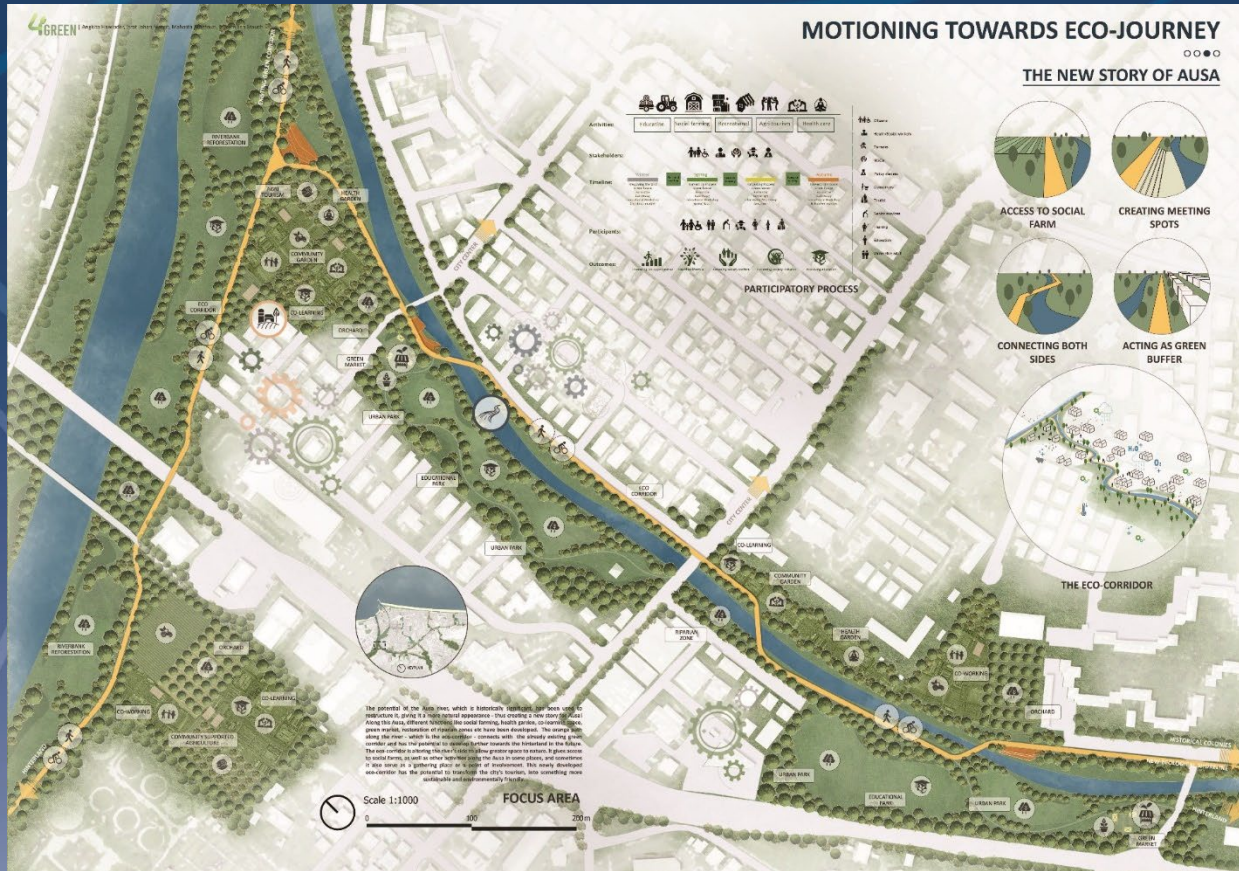

SOCIAL FARMING



SOCIAL MARKET



BANK OF AUSA

LE:NOTRE Landscape Forum 2022, Students' Competition
'Dancing to the Future' (Rimini, Italy) 2nd price

Team: Angkita Hawlander, Israt Jahan Nishat, Mahasta Mahfouzi, Maximilian Stauch

Competition winners

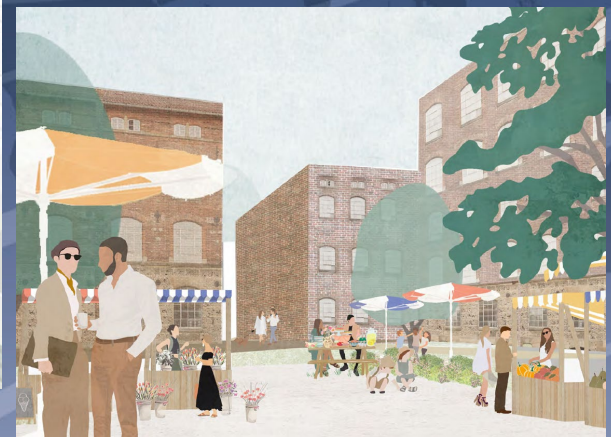
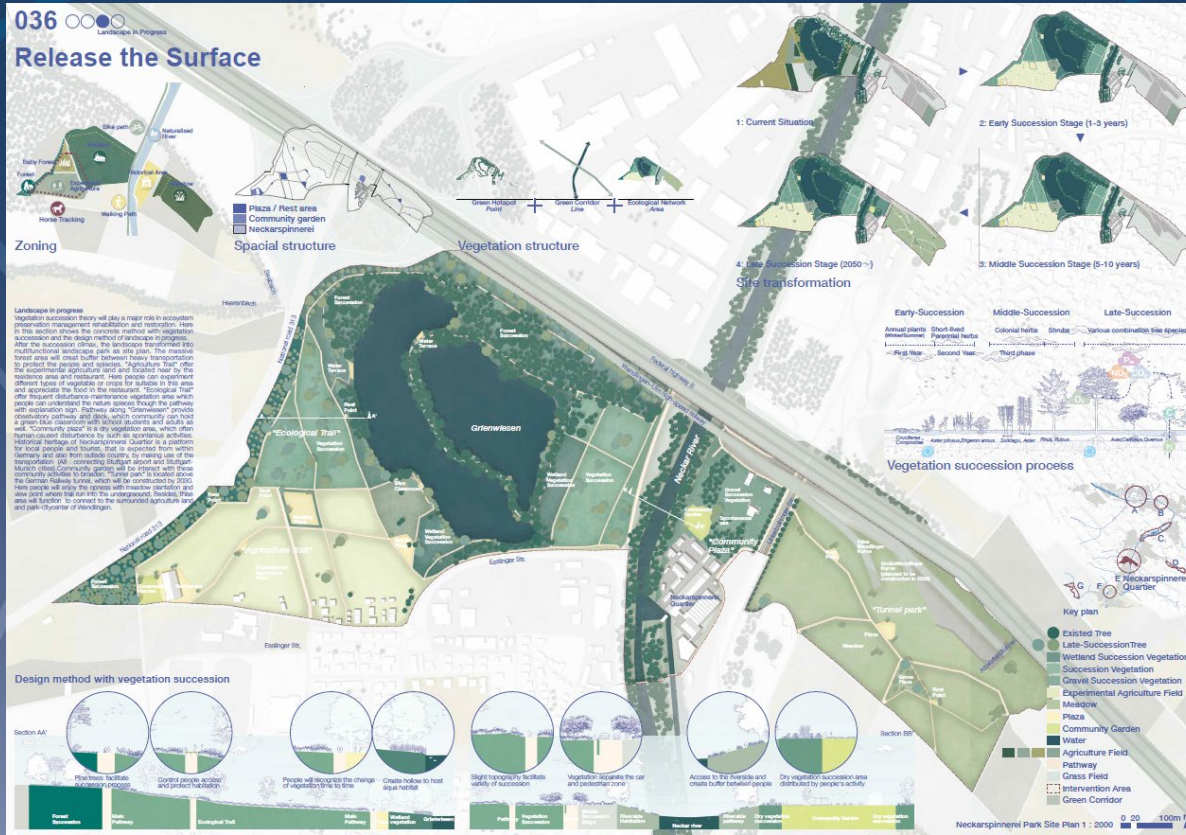

LE:NOTRE Landscape Forum 2023, Students' Competition
 'Neckar Landscape Park – Re-imagining the Productive City Region' (Germany) 2nd price
 Yuga Tanaka

Interest?



- Start: Every summer term (15 March)
- Application deadline: 15 November
- Requirements: Bachelor's degree in Landscape Architecture or related disciplines with a planning and spatial relevance
- Further criteria: Content relevance of the Bachelor's thesis, relevant professional experience, portfolio.
Students with a 3-year degree or a degree other than Landscape Architecture must complete a 18-week internship in the 3rd semester.
- Teaching language: English, Level B2 (CEFR) is to be verified
- Learn more: www.imla-campus.eu
(including the IMLA image movie)
- Application procedure: <https://www.hfwu.de/en/studium/application/master-application/#c76059>
- Recognition of certificates procedure: <https://www.htwg-konstanz.de/en/academics/center-for-international-students-konstanz/recognition-of-certificates/procedure>



imla 2024 wants you!

**Apply by 15 November 2023 for a start
in March 2024 in Freising-Weihenstephan
(or by 15 November 2024 for a start
in March 2025 in Nürtingen)...**



...to shape our green future!