



**imla**

International  
Master of Landscape  
Architecture

Broaden your horizon:  
Welcome to the internationally recognised  
Master's programme in Landscape Architecture



Photo: Ellen Fetzer



The International Master's Programme in Landscape Architecture (known as the IMLA programme) is a cooperation between two renowned universities in Germany:

- **Nürtingen-Geislingen University (HfWU)**  
in Nürtingen (Baden-Württemberg)
- **Weihenstephan · Triesdorf University of Applied Sciences (HSWT)**  
in Freising (Bavaria)



**WEIHENSTEPHAN · TRIESDORF**  
University of Applied Sciences



# Location of the IMLA partner universities



The location of studies alternates annually between Nürtingen and Freising-Weihenstephan – depending on the year of the application

- Nürtingen-Geislingen University of Applied Sciences (HfWU) near Stuttgart (Baden-Wuerttemberg)
- Weihenstephan · Triesdorf University of Applied Sciences (HSWT) near Munich (Bavaria)





# Definition of Landscape Architecture



IMLA follows the definition coined by ECLAS, the European Council of Landscape Architecture Schools:

‘Landscape architecture as a field of professional activity, and an academic discipline, is concerned with the shaping of landscapes at **various scales**.

Core competences of landscape architecture centre on the process of intervention in landscapes to create new or revitalised places, by means of **landscape planning, design and management**, as well as by project implementation.’

Tuning Document, 2011





... means landscape unlimited



Shaping transformation,  
planning and designing landscape  
with innovative methods  
and in international contexts





# What does the programme offer?



## Planning and design in Europe and beyond:

- Broaden your horizon in international contexts
- Learn about different (planning) cultures
- Develop your self-confidence





# What does the programme offer?



## Preparation for management functions:

- Organisational foresight, team building and leadership in projects
- Project and process management
- Public relations, communication and participation





# What does the programme offer?



Working efficiently in (interdisciplinary and intercultural) teams:

- Teamwork and interdisciplinarity, intercultural communication
- Time management and work flow
- Planning and design methods and international approaches





# What does the programme offer?



Creating ideas and solutions for landscapes throughout Europe:

- Current project tasks in different contexts
- Intensive studio work and landscape architecture research
- Application and development of digital technologies and tools

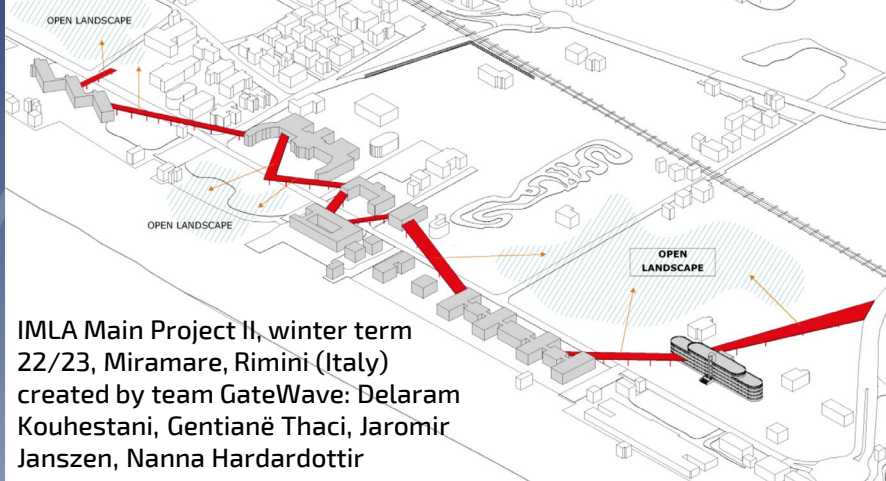



# The IMLA concept (course contents)



LAS

Landscape as System

PPM

Planning and Project Management

IT

Information Technologies

PDM

Planning and Design Methods

IPD

International Planning and Design

Semester 3: Master Thesis and Elective

Semester 1 + 2 Projects and Design Studios

Theoretical basics – 5 pillars



# Programme 2025 – 2027

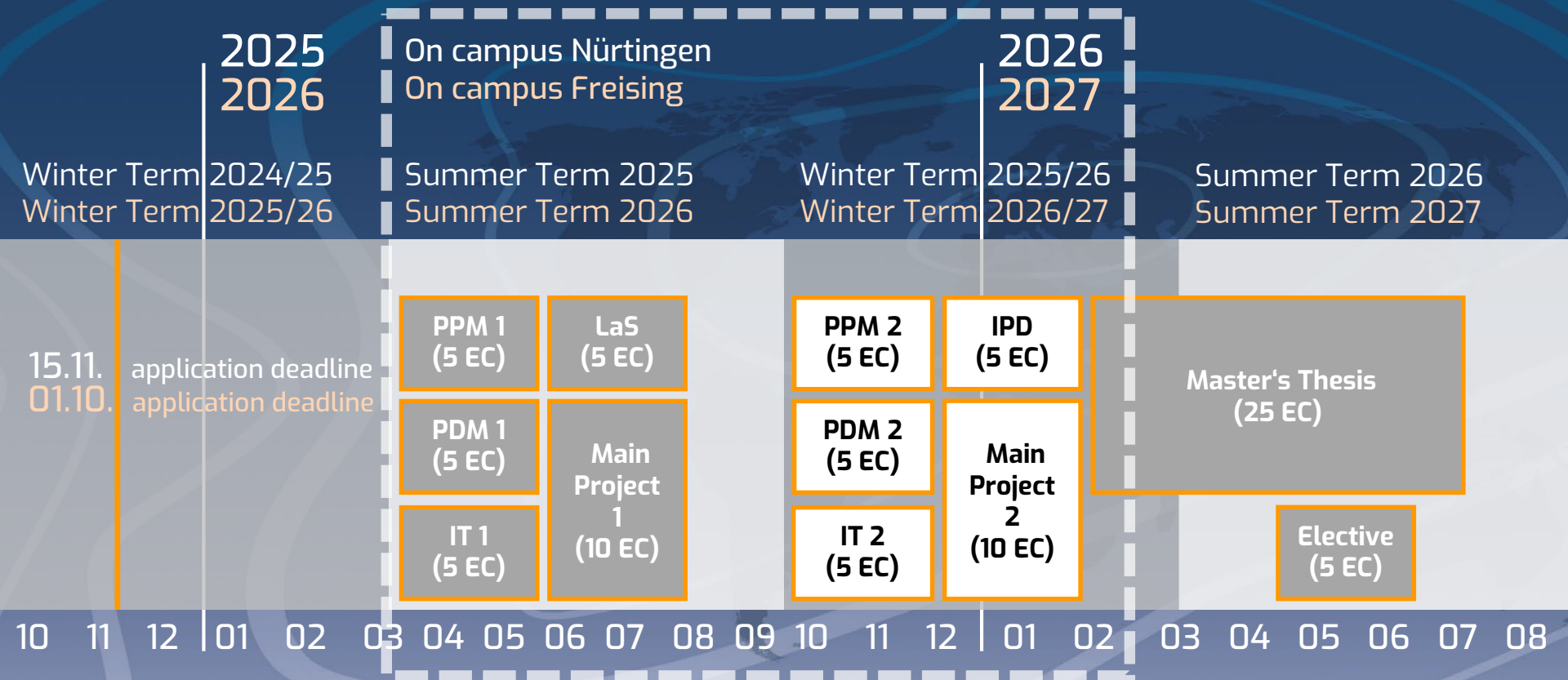

Students with a 3-year degree or a degree other than Landscape Architecture must complete a 18-week (90 days) internship at a Landscape Architecture Office before starting their Master's thesis.



# Where do our students come from?

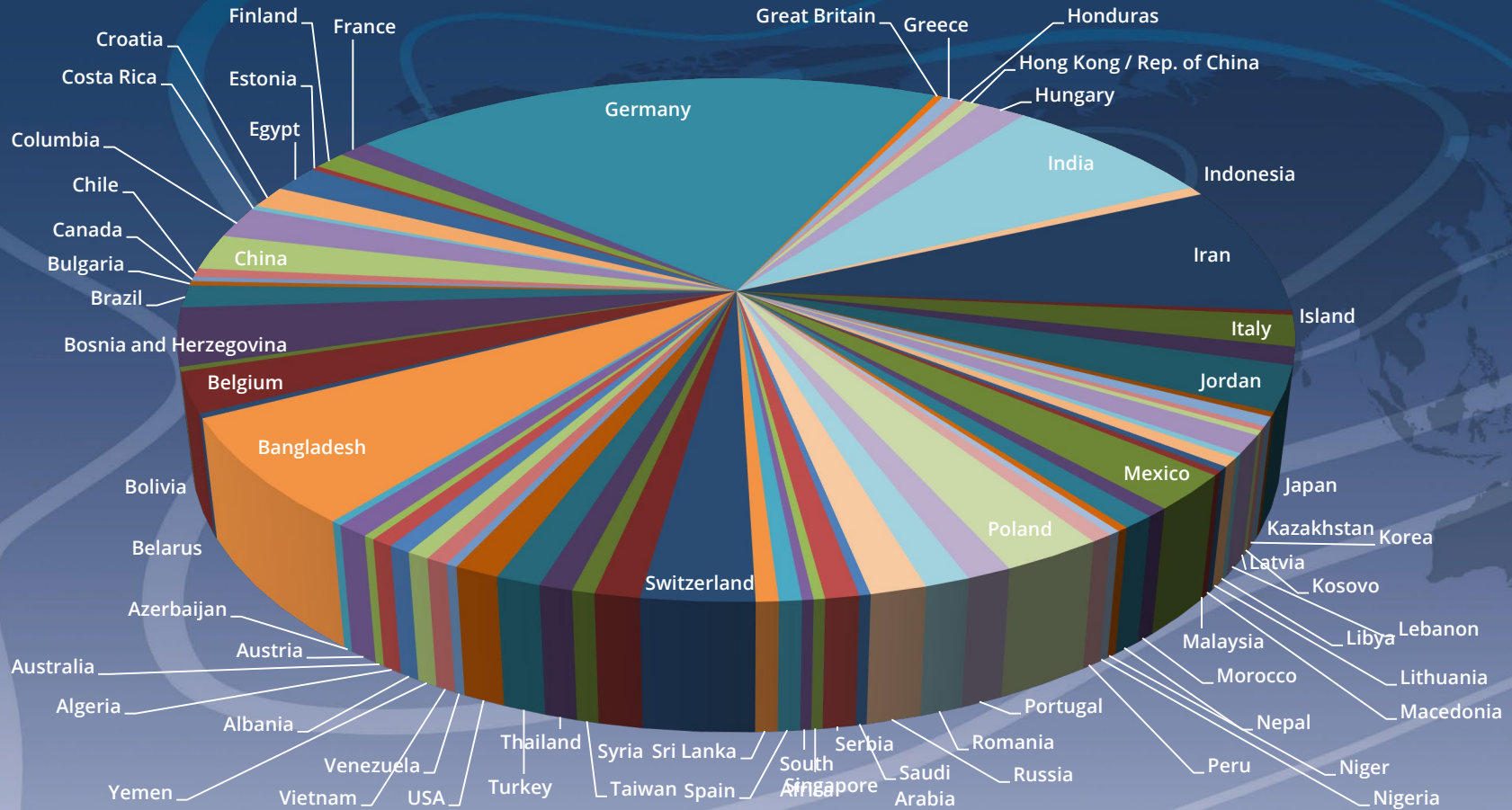



# IMLA students Weihenstephan 2022 – 2024

26 students from 16 different nations (just graduated)





# IMLA students Nürtingen 2023 – 2025

32 students from 14 different nations (currently in the 4th semester)





# IMLA students Weihenstephan 2024 – 2026

27 students from 15 different nations (currently in the 2nd semester)





# International projects / cooperation with partner universities



- 2011: Targu Mures (Romania) with Corvinus University Budapest
- 2012: Cape Town (South Africa) mit University of Cape Town
- 2013: Bucharest (Romania) with Ion Mincu University Bucharest
- 2014: Bruxelles (Belgium) with Université Libre Buxelles
- 2015: Sarajevo (Bosnia) and Romania (2 groups)
- 2016: Sarajevo (Bosnia)
- 2017: Sighisoara/Schäßburg (Siebenbürgen, Romania), Bergamo (Italy)
- 2018: Mangalia (Romania, Black Sea), Bergamo (Italy), Zagreb (Croatia)
- 2019: Tallinn (Estonia), Naples (Italy), Pula (Croatia), Bratislava (Slovakia)
- 2020: De Panne (Belgium), Düsseldorf (Germany), Gdansk (Poland)
- 2021: Rimini (Italy)
- 2022: Tartu (Estonia), Naples (Italy), Constanta (Romania), Rimini (Italy)
- 2023: Ravenna (Italy), Tartu (Estonia)





# Main Project II (winter term 2019/20): CAMPULA – University Campus Pula (Croatia)

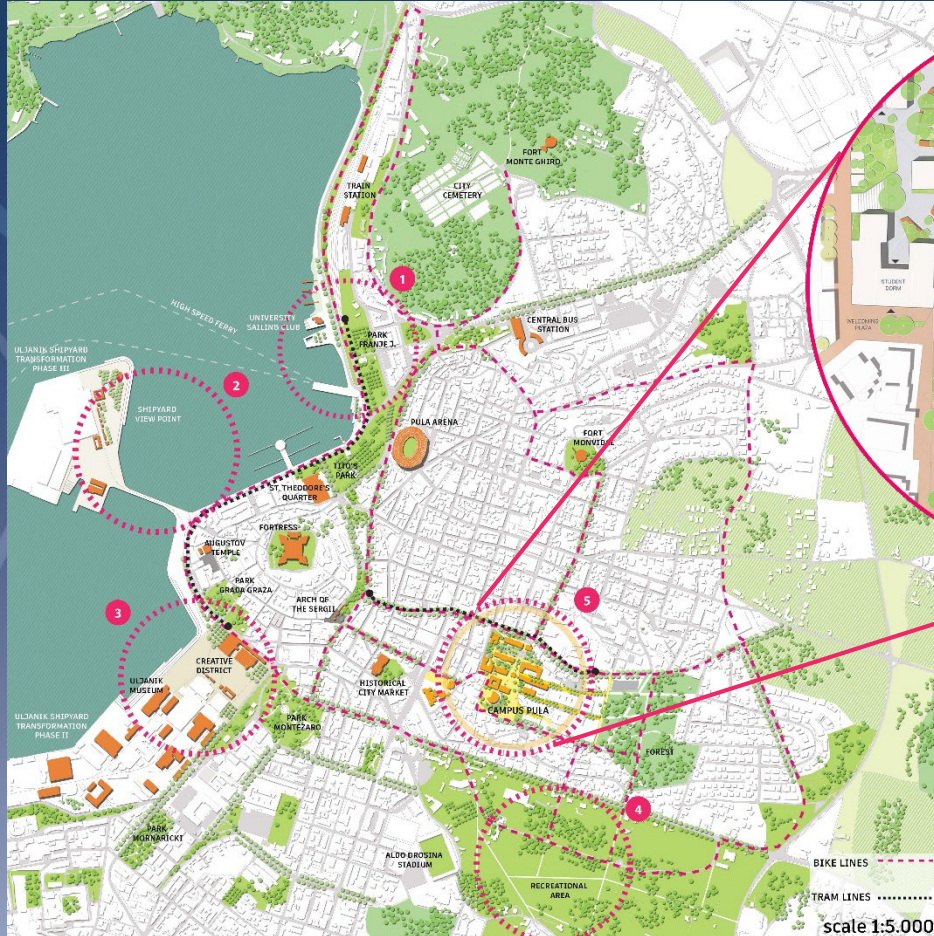

'INTERFACE'  
Team:  
Darja Korjukina,  
Majeda Khatun,  
Rahnuma Ahmad  
Tahiti,  
Göksen Ezgi Boz





# Main Project II (winter term 2022/23): Urban Acupuncture in Rimini, Italy



Reinvisioning of the  
Ausa canal in Rimini



Team: Ayse Dolanbay, Fabrizio Albion, Kees van Roon, Pasu Vascharaprakarn



# Competition winners



## LE:NOTRE Landscape Forum 2020 Students' Competition 'Cross-Border Landscapes' (Slovakia/Austria/Hungary)

2nd price

Team:

Chiara Loffredi,  
Foyshal Md. Azizul  
Karim,  
Ho Ching Leung,  
Shaurav Paul





# Competition winners



LE:NOTRE Landscape Forum 2021  
Students' Competition  
'The Port Island of the Future'  
(Gdańsk, Poland)

2nd price

Team:

Raquelle El-Khoury, Paul Maksoud,  
Luke Miller, Taha Shayestehpour





# Competition winners



LE:NOTRE Landscape Forum 2022, Students' Competition  
'Dancing to the Future' (Rimini, Italy) 2nd price

Team: Angkita Hawlander, Israt Jahan Nishat, Mahasta Mahfouzi, Maximilian Stauch



# Competition winners

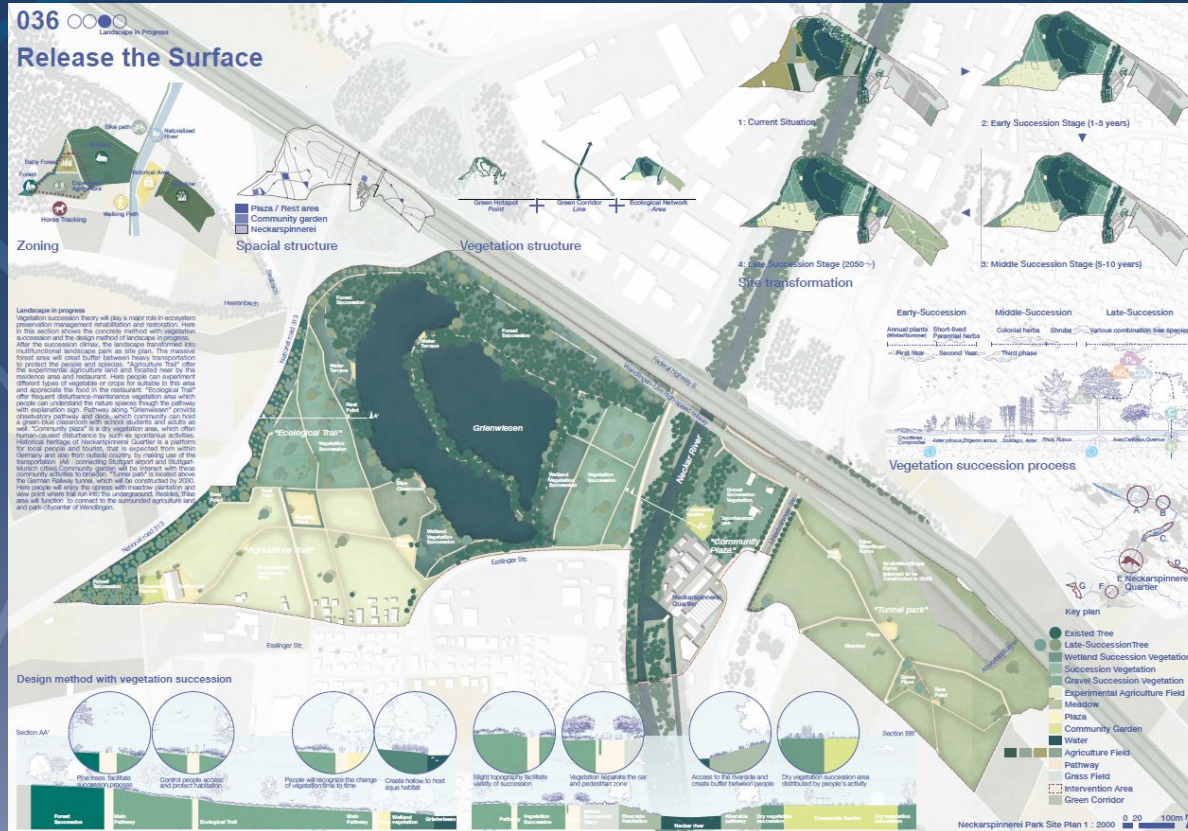

LE:NOTRE Landscape Forum 2023, Students' Competition  
 'Neckar Landscape Park – Re-imagining the Productive City Region' (Germany) 2nd price  
 Yuga Tanaka



# Competition winners



LE:NOTRE Landscape Forum 2024,  
Students' Competition 'Exploring  
Tartu Emajõgi and its watercourses'  
(Tartu, Estonia): 1st price  
Team: Caroline de Vries, Malavika  
Mohan Das, Mahan Esmaeli Zavieh,  
Ernesto Velasquez Gonzalez





# Interest?



Start:	Every summer term (15 March)
Application deadline:	01 October
Requirements:	Bachelor's degree in Landscape Architecture or related disciplines with a planning and spatial relevance
Further criteria:	Content relevance of the Bachelor's thesis, relevant professional experience, portfolio. Students with a 3-year degree or a degree other than Landscape Architecture must complete a 18-week internship in the 3 <sup>rd</sup> semester.
Teaching language:	English, Level B2 (CEFR) is to be verified
Learn more:	<a href="http://www.imla-campus.eu">www.imla-campus.eu</a> (including the IMLA image movie)
Application procedure:	<a href="https://www.hfwu.de/en/studium/application/master-application/#c76059">https://www.hfwu.de/en/studium/application/master-application/#c76059</a> <a href="https://www.imla-campus.eu/application">https://www.imla-campus.eu/application</a>
Recognition of certificates procedure:	<a href="https://www.htwg-konstanz.de/en/academics/center-for-international-students-konstanz/recognition-of-certificates/procedure">https://www.htwg-konstanz.de/en/academics/center-for-international-students-konstanz/recognition-of-certificates/procedure</a>





# wants you!

Apply by 01 October 2025 for a start  
in March 2026 in Freising-  
Weihenstephan (HSWT)  
(or by 01 October 2026 for a start  
in March 2027 in Nürtingen (HfWU))

## Let's shape our green future!



<https://www.imla-campus.eu/>